

'Feel
your Airport'

Primary Cable is the Backbone

GE-TED

Elevated Taxiway Edge Light

Standard compliance

ICAO

Aerodrome Design Manual
Annex 14, Volume 1

EASA

CS-ADR-DNS Issue 5

AENA

DIN/DSEYN/PPT/019-03/12

STAC

SPE/SE/E/VIS/6008

IEC

61827

FAA

AC150/5345-46, EB67

Use

Elevated Taxiway Edge Light

Description

Low consumption dimmable LED light (EB67).

Compatible with existing AGL infrastructures (6.6A IEC/FAA CCRs, thyristor or IGBT).

Transformerless architecture with low inrush current and high power factor.

Cast aluminium body -UV-resistant powder coating.

Shared parts across the whole range of lights thanks to a modular design, to reduce spare references.

Open fail monitoring capability.

Surge protection.

Technical Data

Environment	
Operating temperature	-55°C/+55°C
Storage temperature	-55°C/+85°C
Protection index	IP68
Humidity	0%-100%
Mechanical	
Width	99mm
Height	144,5mm
Weight	0,66kg
Electrical	
Power Supply	2,8A - 6,6A
Max admissible current	12A
Power Consumption	<5,5W
Power factor	>97%
Life span	>80000H

Drawing

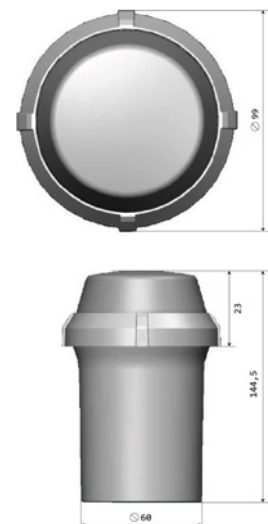

Chromaticity

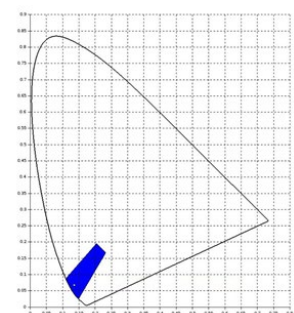

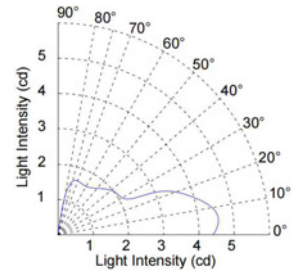

Blue

Components and spare parts

Drawing Reference	Part	Code
1, 3 and 7	Elevated omnidi. light body, cable assembled	ELEVBOD0000
2	Lens for GE-TED	ELEVBOD0001
3	Seal ring for elevated omnidi. light	ELEVBOD0002
7	Light cable lead 40cm long with gland	LIAC0000000
4	LED lights source B2R1F	ELEVLEDB001
5	Driver module	LIACINT0006
-	Breakable coupling	LIACINSEL01
-	Baseplate 187mm	LIACINSEL00

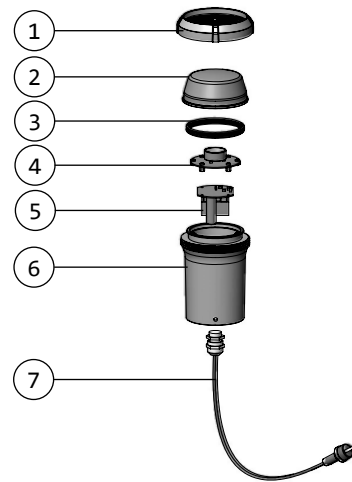

Ordering Code

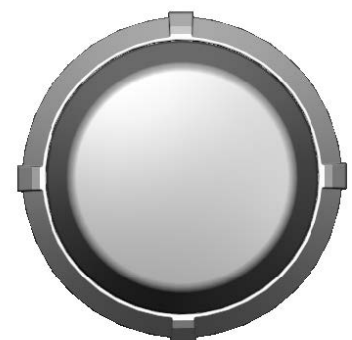
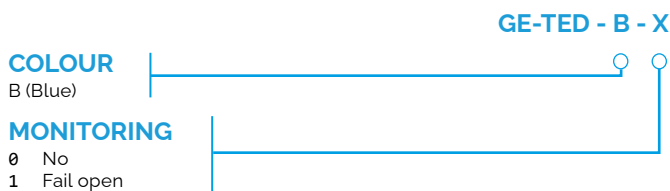



GRP Iluminación, S.A.U.

Calle de los Reyes Católicos, 6. Nave 102
28108 - Alcobendas (Madrid) - Spain / +34 91 327 19 66



GRP

www.grp-airsys.com